



GROUP - 24

ACCESSORIES FOR BOTECA PRODUCTS

Accessories for BOTECA products

This group features some spare parts or accessories for all BOTECA handgrips. Hole cover caps for the articles of groups C-D-E, safety chains, adhesive badges, nuts and thrust nose pins. For detailed information on the specifications of each individual product please consult the technical sheet.

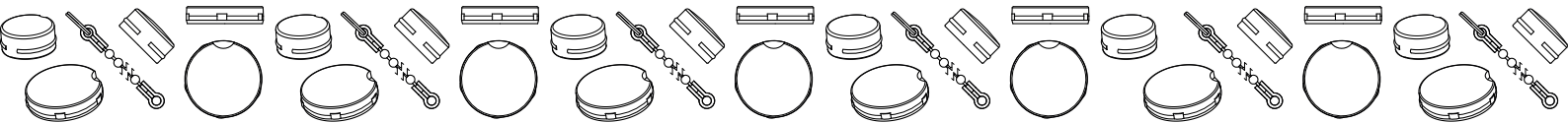

TAP



HOLE COVER CAP FOR "EUROMODEL" WING NUTS

Materials:

Polyamide with ABS.
Resistant to oils and greases.

Surface finish:

Satin.

Colour:

Grey RAL 7035 code 13.(standard).

Fixing method:

Push-fit.

Alternative cap colours:

Orange (RAL 2004 code 02).
Blue (RAL 5015 code 07).
Yellow (RAL 1021 code 10).
Red (RAL 3000 code 16).
Green (RAL 6024 code 17).
Black (RAL 9011 code 01).

Special requests:

- None.

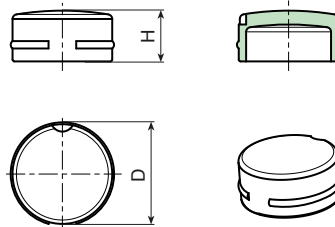

Version: 01 - Black RAL 9011

Code	art.	D	H	g
-	TAP.1101	11	5,5	0,1
-	TAP.1301	13	6,5	0,2
-	TAP.1601	16	7,5	0,3

Version: 02 - Orange RAL 2004

Code	art.	D	H	g
-	TAP.1102	11	5,5	0,1
-	TAP.1302	13	6,5	0,2
-	TAP.1602	16	7,5	0,3

Version: 07 - Blue RAL 5015

Code	art.	D	H	g
-	TAP.1107	11	5,5	0,1
-	TAP.1307	13	6,5	0,2
-	TAP.1607	16	7,5	0,3

Version: 10 - Yellow RAL 1021

Code	art.	D	H	g
-	TAP.1110	11	5,5	0,1
-	TAP.1310	13	6,5	0,2
-	TAP.1610	16	7,5	0,3

Version: 13 - Grey RAL 7035

Code	art.	D	H	g
-	TAP.1113	11	5,5	0,1
-	TAP.1313	13	6,5	0,2
-	TAP.1613	16	7,5	0,3

Version: 16 - Red RAL 3000

Code	art.	D	H	g
-	TAP.1116	11	5,5	0,1
-	TAP.1316	13	6,5	0,2
-	TAP.1616	16	7,5	0,3

Version: 17 - Green RAL 6024

Code	art.	D	H	g
-	TAP.1117	11	5,5	0,1
-	TAP.1317	13	6,5	0,2
-	TAP.1617	16	7,5	0,3

COP

HOLE COVER CAP FOR C-D-E-G-I-M-N SERIES



Materials:

Polyamide with ABS.

Resistant to oils and greases.

Surface finish:

Satin.

Colour:

Grey RAL 7035 code 13.(standard).

Fixing method:

Push-fit.

Alternative cap colours:

Orange (RAL 2004 code 02).

Blue (RAL 5015 code 07).

Yellow (RAL 1021 code 10).

Red (RAL 3000 code 16).

Green (RAL 6024 code 17).

Black (RAL 9011 code 01).

Special requests:

- None.

PAD PRINTING SERVICE

Upon request and for special quantities caps can be supplied with custom pad printing.

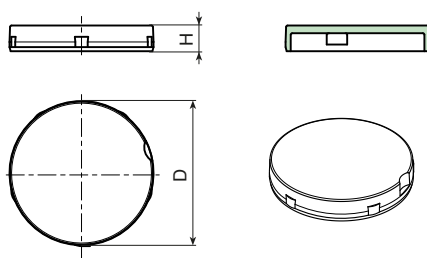

Version: 01 - Black RAL 9011

Code	art.	D	H	g
-	COP.1601	16	2,2	0,1
-	COP.1801	18	3	0,7
-	COP.2001	20	5	0,8
-	COP.2201	22	5	0,9
-	COP.2601P	26	5	1,2
-	COP.2801P	28	5	1,3
-	COP.3401	34	5	1,8
-	COP.4001	40	6	3
-	COP.5201	52	6	-
-	COP.5501	55	6	-

Version: 02 - Orange RAL 2004

Code	art.	D	H	g
-	COP.1602	16	3	0,5
-	COP.1802	18	3	0,7
-	COP.2002	20	5	0,8
-	COP.2202	22	5	0,9
-	COP.2602P	26	5	1,2
-	COP.2802P	28	5	1,3
-	COP.3402	34	5	1,8
-	COP.4002	40	6	3

Version: 07 - Blue RAL 5015

Code	art.	D	H	g
-	COP.1807	18	3	0,7
-	COP.2007	20	5	0,8
-	COP.2207	22	5	0,9
-	COP.2607P	26	5	1,2
-	COP.2807P	28	5	1,3
-	COP.3407	34	5	1,8
-	COP.4007	40	6	3
-	COP.5507	55	6	-



Version: 10 - Yellow RAL 1021

Code	art.	D	H	g
-	COP.1810	18	3	0,7
-	COP.2010	20	5	0,8
-	COP.2210	22	5	0,9
-	COP.2610P	26	5	1,2
-	COP.2810P	28	5	1,3
-	COP.3410	34	5	1,8

Version: 13 - Grey RAL 7035

Code	art.	D	H	g
-	COP.1613	16	3	0,5
-	COP.1813	18	3	0,7
-	COP.2013	20	5	0,8
-	COP.2213	22	5	0,9
-	COP.2613P	26	5	1,2
-	COP.2813P	28	5	1,3
-	COP.3413	34	5	1,8
-	COP.4013	40	6	3
-	COP.5213	52	6	-
-	COP.5513	55	6	-
-	COP.6713	67	6	-

Version: 16 - Red RAL 3000

Code	art.	D	H	g
-	COP.1616	16	2,2	0,1
-	COP.1816	18	3	0,7
-	COP.2016	20	5	0,8
-	COP.2216	22	5	0,9
-	COP.2616P	26	5	1,2
-	COP.2816P	28	5	1,3
-	COP.3416	34	5	1,8
-	COP.4016	40	6	3
-	COP.5516	55	6	-

Version: 17 - Green RAL 6024

Code	art.	D	H	g
-	COP.2017	20	5	0,8
-	COP.2217	22	5	0,9
-	COP.2617P	26	5	1,2
-	COP.2817P	28	5	1,3
-	COP.3417	34	5	1,8

COP.H4

HOLE COVER CAP, HEIGHT 4, FOR B SERIES



Materials:

Polyamide with ABS.

Resistant to oils and greases.

Surface finish:

Satin.

Colour:

Grey RAL 7035 code 13.(standard).

Fixing method:

Push-fit.

Alternative cap colours:

Orange (RAL 2004 code 02).

Blue (RAL 5015 code 07).

Yellow (RAL 1021 code 10).

Red (RAL 3000 code 16).

Green (RAL 6024 code 17).

Black (RAL 9011 code 01).

Special requests:

- None.

PAD PRINTING SERVICE

Upon request and for special quantities caps can be supplied with custom pad printing.

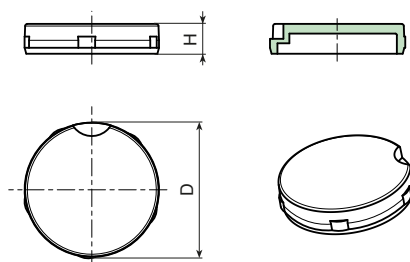

Version: 01 - Black RAL 9011

Code	art.	D	H	g
-	COP.D16H401	16	4	0,2
-	COP.D18H401	18	4	1

Version: 02 - Orange RAL 2004

Code	art.	D	H	g
-	COP.D16H402	16	4	0,2
-	COP.D18H402	18	4	1

Version: 07 - Blue RAL 5015

Code	art.	D	H	g
-	COP.D16H407	16	4	0,2
-	COP.D18H407	18	4	1

Version: 10 - Yellow RAL 1021

Code	art.	D	H	g
-	COP.D16H410	16	4	0,2
-	COP.D18H410	18	4	1

Version: 16 - Red RAL 3000

Code	art.	D	H	g
-	COP.D16H416	16	4	0,2
-	COP.D18H416	18	4	1

Version: 17 - Green RAL 6024

Code	art.	D	H	g
-	COP.D16H417	16	4	0,2
-	COP.D18H417	18	4	1



CIL

PLASTIC CYLINDER FOR THREADED STUD



Materials:

Reinforced polyamide.
Resistant to oils and greases.

Surface finish:

Satin.

Colour:

Black: (RAL 9011 code 01).

Fixing method:

Push-fit.

Special requests:

- None.

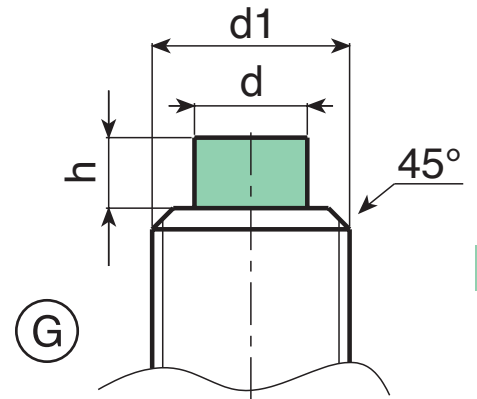
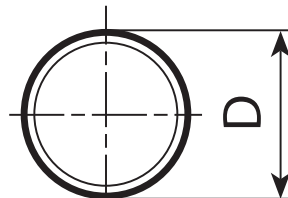
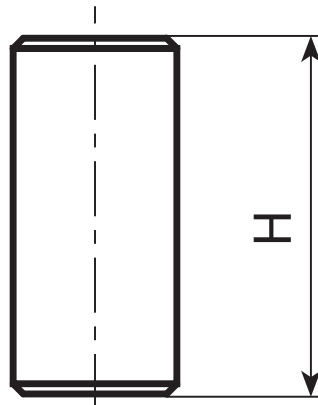

Code	art.	D	H	g
-	CIL.T03X6	3	6	0,1
-	CIL.T05X7	5	7	0,3
-	CIL.T06X7	6	7	0,4

KITCAT

RETAINING CHAIN KIT



Materials:

Acetal (POM) chain.

Harmonic stainless steel joint (AISI 302).

Harmonic stainless steel ring (AISI 302).

Surface finish:

Satin.

Colour:

Black: (RAL 9011 code 01).

Special requests:

- Upon request the chain can be supplied with customised lengths.

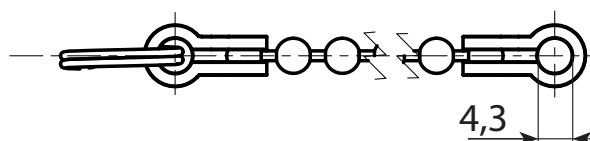
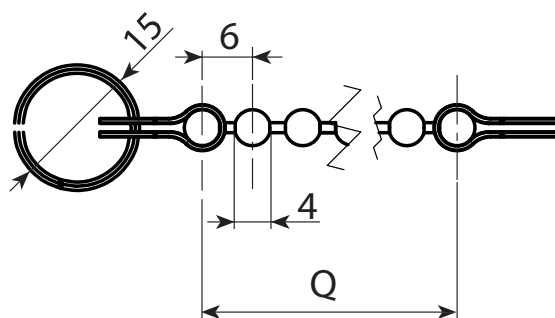

24

Code	art.	Q	g
-	KIT.CAT100	100	5
-	KIT.CAT200	200	10
-	KIT.CAT300	300	15

ADHESIVE BADGE IN POLYURETHANE RESIN - CUSTOMISABLE

Materials:

Bicomponent polyurethane resin badge, transparent.
With printable adhesive base.

Surface finish:

Smooth.

Colour:

Transparent.

Fixing method:

With adhesive bottom.

Customisation:

On the bottom of the adhesive badge we can print logos, trademarks, texts, pictograms or any other drawing or picture. Printing will be in four-colour. The resin badge has a slightly lenticular section which tends to magnify the image below. The adhesive badge is designed to be applied to the caps or covers of our handwheels, or to fit into the recesses on the F and G series knobs. It can also be sold separately. This option allows a better protection for the print while highlighting the underlying image. Moreover, the result lasts considerably more than a standard pad printing.

Special requests:

- Adhesive badges can be produced with customised diameters, provided that the minimum quantity necessary for the diameter customisation is reached.

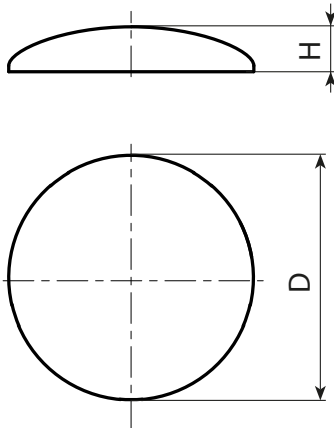

Code	Art.	D	H	g
-	X.ET09.7.....	9,7	1,8	0,1
-	X.ET10.4.....	10,4	1,8	0,13
-	X.ET11.4.....	11,4	1,8	0,15
-	X.ET12.2.....	12,2	1,8	0,20
-	X.ET14.0.....	14	1,8	0,25
-	X.ET17.0.....	17	2	0,40
-	X.ET18.0.....	18	2	0,50
-	X.ET19.0.....	19	2	0,60
-	X.ET23.8.....	23,8	2	1
-	X.ET27.0.....	27	2	1,5
-	X.ET33.0.....	33	2	2

Insert the customer code in the place of the dots of the article code.

Materials:

Versions FZ, FB:

Standard steel, property class 4.8.

Version IN:

Stainless steel (Aisi 304).

Surface finish:

Smooth.

Colour:

Versions FZ, FB:

Standard steel, property class 4.8.

Version IN:

Stainless steel (Aisi 304).

Special requests:

- None.

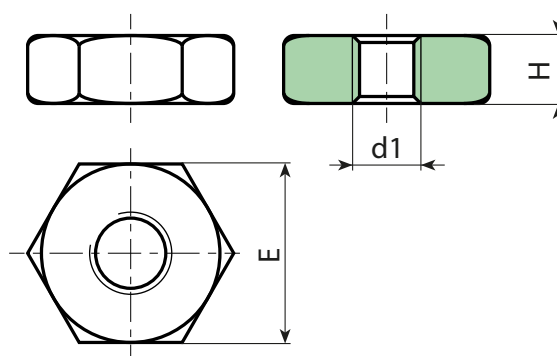

Black oxide treated steel version

Code	Art.	E	H	d1 6H	p	g
-	DAM.FBEM05	8	4	M5	0,8	1
-	DAM.FBEM06	10	5	M6	1	2,5
-	DAM.FBEM08	13	6,5	M8	1,25	5
-	DAM.FBEM10	17	8	M10	1,5	12

Galvanised steel version.

Code	Art.	E	H	d1 6H	p	g
-	DAM.FZEM05	8	4	M5	0,8	1
-	DAM.FZEM06	10	5	M6	1	2,5
-	DAM.FZEM08	13	6,5	M8	1,25	5
-	DAM.FZEM10	17	8	M10	1,5	12
-	DAM.FZEM12	19	10	M12	1,75	17
-	DAM.FZEM16	24	13	M16	2	33
-	DAM.FZEM20	30	16	M20	2,5	65
-	DAM.FZEM24	36	19	M24	3	110

INOX

Stainless steel version.

Code	Art.	E	H	d1 6H	p	g
-	DAM.HNEM06	10	5	M6	1	2,5
-	DAM.HNEM08	13	6,5	M8	1,25	5
-	DAM.HNEM10	17	8	M10	1,5	12
-	DAM.HNEM12	19	10	M12	1,75	17
-	DAM.HNEM16	24	13	M16	2	33
-	DAM.HNEM20	30	16	M20	2,5	65
-	DAM.HNEM24	36	19	M24	3	110