

# W136CIN



13

## FULL STAINLESS STEEL FOLDING HANDLE

Metalline Pomelli

**Materials:**

Stainless steel (Aisi 303).

**Surface finish:**

Sandblasted satin finish.

**Colour:**

Natural.

**Thread:**

Threaded stud obtained by turning (thread tolerance 6g).

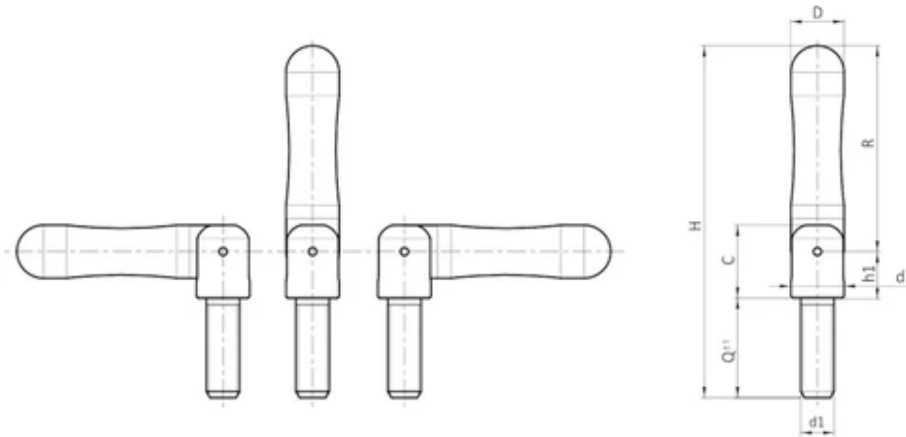

Code	art.	D	R	H	C	h1	d	d1 6g	Q	Weight (g)
W136062.0001	W136062.IM10X30CIN	16	62	106	22	14	16	M10	35	118