

KNURLED KNOB WITH INSERT WITH SMOOTH HOLE

Manicotti zigrinati

Control knob with wide knurling suitable to be gripped with a full hand, to move, control and adjust machine axes with precision. The large knurling allows excellent grip both with and without gloves. Wrapping the entire palm of the hand, if it needs to impart force, or only with the fingers for small and precise movements. Prepared to be connected, with three screws, to its natural accessory such as the numbered flange (NFLAN). This flange can be black or gray and has different numbering gradations or just one reference mark. Designed to replace the more expensive ones in metal and aluminum. The insert hole has a small pilot diameter, but BOTECA is able, even on small batches, to customize this hole and adapt it to the customer's needs. To close this hole we find a convenient removable cap, available in different colors and easy to customize by pad printing. Product suitable for manual machine tools, drills, drilling machines, packaging machines, saws and hacksaws, packaging machines, food equipment. The N246 knurled sleeve is made of polyamide based materials reinforced with stabilizing additives, to ensure excellent flatness and circularity. This model is a basic version, but it can be requested in different variants such as the Knurled control knob with lock system, the indexed steel control knob, or the control knob with a continuously variable movement, etc.).

Materials:

Reinforced polyamide.
Resistant to oils and greases.

Surface finish:

Satin.

Colour:

Black (RAL 9011).

Cap:

Central cap in grey polyamide (RAL 7035).

Inserts:

Galvanised steel insert with smooth through bore (tolerance H10).

Notes:

(*) Side NFLAN flange fixing (optional).

Special requests:

Upon request and for special quantities inserts can be supplied with custom hole diameter d1.

Upon request and for special quantities inserts can be supplied in different materials/with different coatings.

Upon request and for special quantities available in the colours indicated in the chart (attention: reduced range).



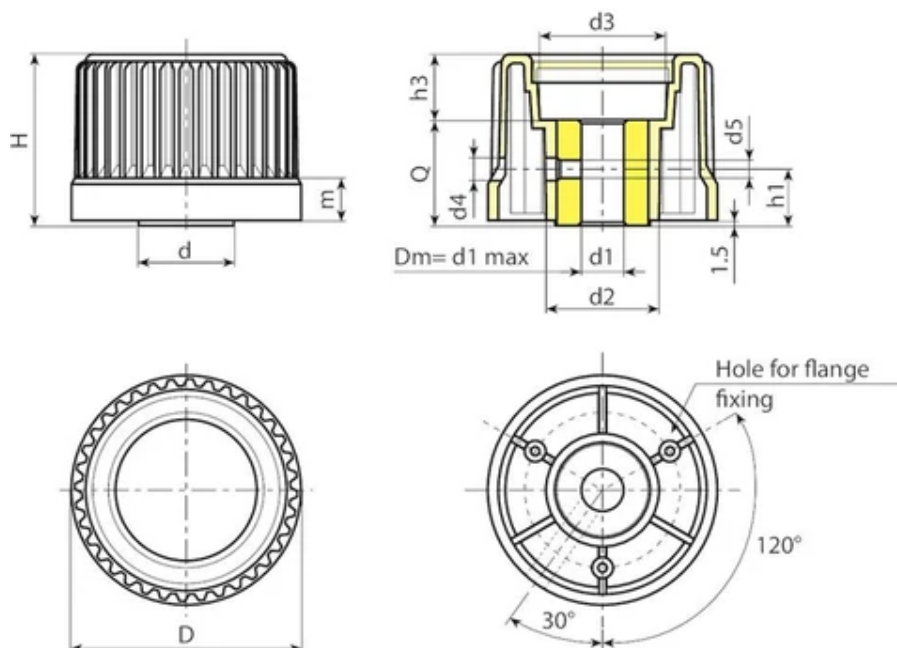

Code	Art.	D	H	m	d	d2	d3	d4	d5	h1	h3	Dm	d1 H10	Q	Weight (g)
N24630.0001	N24630.TD060113(*)	30	31,5	11,5	20	-	18	4,5	M4	16	5,5	12	6	26	74
N24630.0005	N24630.TD080113(*)	30	31,5	11,5	20	-	18	5,5	M5	16	5,5	12	8	26	70
N24643.0004	N24643.TD080113	43	37,5	11,5	22	27,5	23	5,5	M5	16	13,5	12	8	24	89
N24654.0001	N24654.TD080113	54	43,5	12	26	32	31	5,5	M5	16	13,5	14	8	30	180
N24654.0005	N24654.TD120113	54	43,5	12	26	32	31	6,5	M6	16	13,5	14	12	30	140
N24665.0001	N24665.TD080113	65	48,5	12	27	32	36	5,5	M5	16	18,5	16	8	30	180
N24665.0007	N24665.TD120113	65	48,5	12	27	32	36	6,5	M6	16	18,5	16	12	30	165
N24665.0009	N24665.TD140113	65	48,5	12	27	32	36	6,5	M6	16	18,5	16	14	30	156
N24678.0002	N24678.TD080113	78	55,5	12,5	31	36	50	6,5	M6	18	23,5	18	8	32	260

Attention: For a minimum of 100 pieces the diameter d1 can be produced with the requested diameter with H10 tolerance.
Dm = Maximum obtainable diameter for subsequent machining (widening).