

09

CONICAL KNOB "EUROMODEL" WITH CAP AND PLASTIC THREADED HOLE

Impugnatura Euromodel

Materials:

Reinforced polyamide.

Resistant to oils and greases.

Surface finish:

Satin.

Colour:

Black (RAL 9011).

Central cap:

Grey polyamide (RAL 7035). 13).

Alternative cap colours:

Orange (RAL 2004 code 02).

Blue (RAL 5015 code 07).

Yellow (RAL 1021 code 10).

Red (RAL 3000 code 16).

Green (RAL 6024 code 17).

Black (RAL 9011 code 01).



Hole:

Female threaded hole obtained by moulding the plastic (thread tolerance not applicable).

Special requests:

Upon request and for special quantities available in the colours indicated in the chart.

PAD PRINTING SERVICE

Upon request and for special quantities caps can be supplied with custom pad printing.

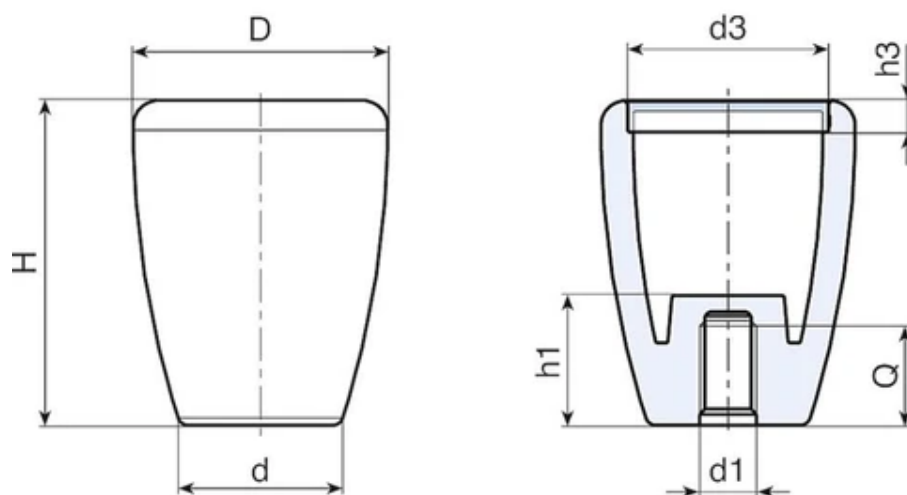

Code	art.	D	H	d	h1	d3	h3	d16H	Q	Weight (g)
I12443.0001	I12443.TM0801	43	55	27	30	34	5.5	M8	24	34
I12443.0003	I12443.TM1001	43	55	27	30	34	5.5	M10	24	32
I12443.0006	I12443.TM1201	43	55	27	30	34	5.5	M12	24	30