

E520



05

INDEXED CRANK HANDLE WITH SMOOTH BORE INSERT AND REVOLVING HANDLE

Manovelle scatto

Material:

Reinforced polyamide. Resistant to oils and greases.

Surface finish:

Satin.

Colour:

Black (RAL 9011).

Inserts:

Galvanised steel insert with blind smooth bore (bore tolerance H10).

Lateral insert:

Brass insert with threaded through hole.

Spring:

Stainless steel spring (Aisi 302).

Fixing screw:

Black oxide treated steel screw with slotted head.

Lateral handle:

Revolving handle art. M144.

Special requests:

Upon request and for special quantities inserts can be supplied in different materials.

Upon request and for special quantities lever body available in the colours indicated in the chart.



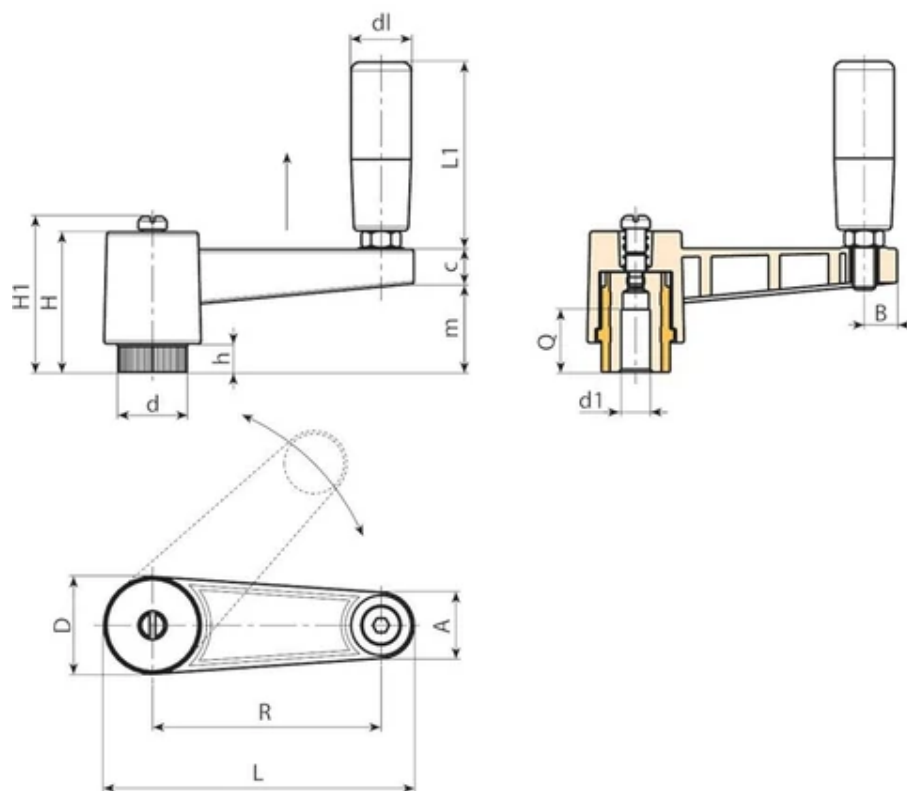

Code	Art.	L	R	H	D	d	m	c	A	B	h	H1	d1	H10	Q	dl	L1	Weight (g)
E520065.0003	E520065.TP0501	88,5	65	46	27	19	29	13	17	9	10	-	5	22	19	54	83	
E520080.0006	E520080.TP0501	109	80	50	34	24,5	33	13	22	12	11	54	5	28	21	66	177	
E520110.0004	E520110.TP0501	139	110	50	34	24,5	33	13	22	12	11	54	5	28	21	66	200	