

## THREE-ARM CONTROL HANDWHEEL WITH SMOOTH OR THREADED HOLE

Volantini a braccia

### Materials:

Reinforced and stabilized polyamide.

Resistant to oils and greases.

### Surface finish:

Satin.

### Colour:

Black (RAL 9011).

### Central cap:

Grey polyamide (RAL 7035). 13).

### Alternative cap colours:

Orange (RAL 2004 code 02).

Blue (RAL 5015 code 07).

Yellow (RAL 1021 code 10).

Red (RAL 3000 code 16).

Green (RAL 6024 code 17).

Black (RAL 9011 code 01).

### Main insert:

Version PON:

Brass insert with threaded through hole (thread tolerance 6H).

Version TM:

Galvanised steel insert with threaded through hole (thread tolerance 6H).

Version TD:

Galvanised steel insert with smooth through bore (tolerance H10).

### Fixing method:

For fixing systems, or execution of keyways or square holes, please refer to the technical notes attached to the catalogue.

### Special requests:

On request and with a minimum of 50 pieces, the inserts can be supplied with the hole d1 with H7 tolerance and black-oxide finish.

Upon request and for special quantities inserts can be supplied with custom hole diameter d1.

Upon request and for special quantities the handwheel can be supplied in Orange (RAL 2004 Code 02).

Upon request and for special quantities inserts can be supplied in different materials/with different coatings.



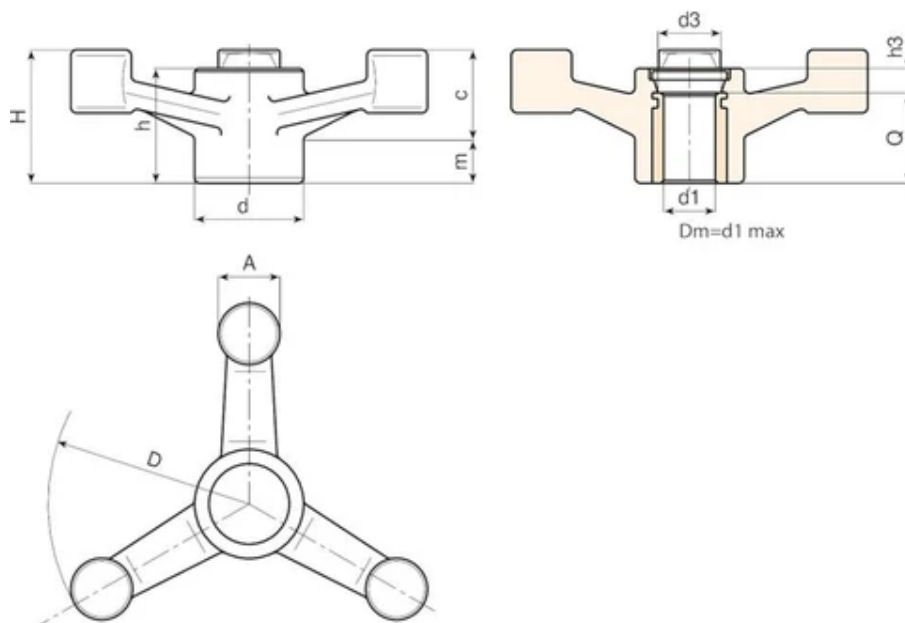

**Version PON with brass insert with threaded through hole.**

Code	Art.	D	H	h	d	m	c	A	h3	d3	d1 6H	Q	Weight (g)
D214140.0020	D214140.TM1401PON	137	45	39.5	38	19	26	22	7.5	26	M14	32	127

Attention: for a minimum of 50 pieces the diameter d1 can be produced with the requested dimensions.

**Version TM with galvanised steel insert and threaded through hole.**

Code	Art.	D	H	h	d	m	c	A	h3	d3	d1 6H	Q	Weight (g)
D214140.0019	D214140.TM1201P	137	45	39.5	38	19	26	22	7.5	26	M12	32	195
D214140.0021	D214140.TM1601P	137	45	39.5	38	19	26	22	7.5	26	M16	32	205
D214180.0015	D214180.TM1601P	177	56	42.5	38	20	35	23	10.5	26	M16	32	265
D214180.0017	D214180.TM1801P	177	56	42.5	38	20	35	23	10.5	26	M18	32	270
D214220.0013	D214220.TM1401P	221	61	46	38	22	39	25	14	26	M14	32	290
D214220.0014	D214220.TM1601P	221	61	46	38	22	39	25	14	26	M16	32	290
D214220.0018	D214220.TM1801P	221	61	46	38	22	39	25	14	26	M18	32	274

Attention: for a minimum of 50 pieces the diameter d1 can be produced with the requested dimensions.

**Version TD with galvanised steel insert with smooth through bore (tolerance H10).**

Code	Art.	D	H	h	d	m	c	A	h3	d3	Dm	d1 H10	Q	Weight (g)
D214140.0005	D214140.TD0801P	137	45	39.5	38	19	26	22	7.5	26	22	8	32	232
D214140.0006	D214140.TD1201P	137	45	39.5	38	19	26	22	7.5	26	22	12	32	220
D214180.0002	D214180.TD0801P	177	56	42.5	38	20	35	23	10.5	26	22	8	32	264

Code	Art.	D	H	h	d	m	c	A	h3	d3	Dm	d1 H10	Q	Weight (g)
D214220.0003	D214220.TD0801P	221	61	46	38	22	39	25	14	26	22	8	32	338
D214220.0010	D214220.TD1801P	221	61	46	38	22	39	25	14	26	22	18	32	330

Attention: For a minimum of 50 pieces the diameter d1 can be customised (hole tolerance H10 galvanised and H7 black-oxide treated).  
Dm = Maximum obtainable diameter for subsequent machining (widening).