

TAPERED HANDWHEEL WITH INSERT AND SMOOTH BORE OR THREADED HOLE

Volantini di manovra vari

Materials:

Reinforced polyamide. Resistant to oils and greases.

Surface finish:

Satin.

Colour:

Black (RAL 9011).

Main insert:

Galvanised steel insert with blind smooth bore (tolerance H10).

Version TM:

Galvanised steel insert with female threaded hole (tolerance 6H).

Special requests:

Upon request and for special quantities inserts can be supplied with custom hole diameter d1.

Upon request and for special quantities inserts can be supplied in different materials or finishes.

Fixing method:

For fixing systems, or execution of keyways or square holes, please refer to the technical notes attached to the catalogue.



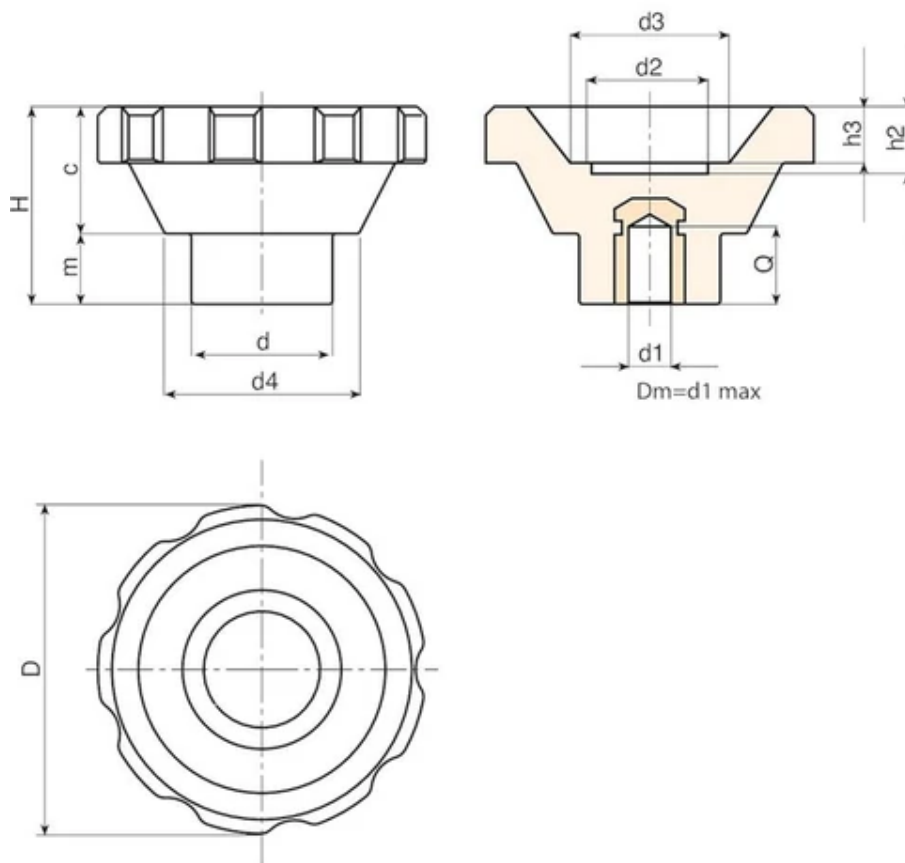

Code	Art.	D	H	d	c	m	d2	d3	d4	h2	h3	Dm	d1 H10	Q	Weight (g)
D16195.0006	D16195.TD0801	93	56.5	40	36.5	20	32	45	55.5	20	17	22	8	27	340

Version TD with blind smooth bore.

Attention: For a minimum of 50 pieces the diameter d1 can be customised (hole tolerance H10 galvanised and H7 black-oxide treated).
Dm = Maximum obtainable diameter for subsequent machining (widening).

Version TM with female threaded hole.

Code	Art.	D	H	d	c	m	d2	d3	d4	h2	h3	d1 6H	Q	Weight (g)
D16195.0019	D16195.TM1201	93	56.5	40	36.5	20	32	45	55.5	20	17	M12	25	338

Attention: for a minimum of 50 pieces the diameter d1 can be produced with the requested dimensions (tolerance 6H).