

FIXED HANDLE FOR CURVED SURFACES WITH INSERT

Maniglie scaricate

This handle is designed for use on round surfaces. The drawing shows the diameter of the surface for which the handle is designed. The handle can also be flexed slightly to best fit the existing holes, or to compensate for small variations in hole diameter or centre distance. One example of this handle's use is on industrial drum top vacuums.

Materials:

Reinforced polyamide.

Resistant to oils and greases.

Surface finish:

Satin.

Colour:

Black (RAL 9011).

Insert:

Brass insert with female threaded hole (thread tolerance 6H).

Special requests:

Upon request and for special quantities available in the colours indicated in the chart.

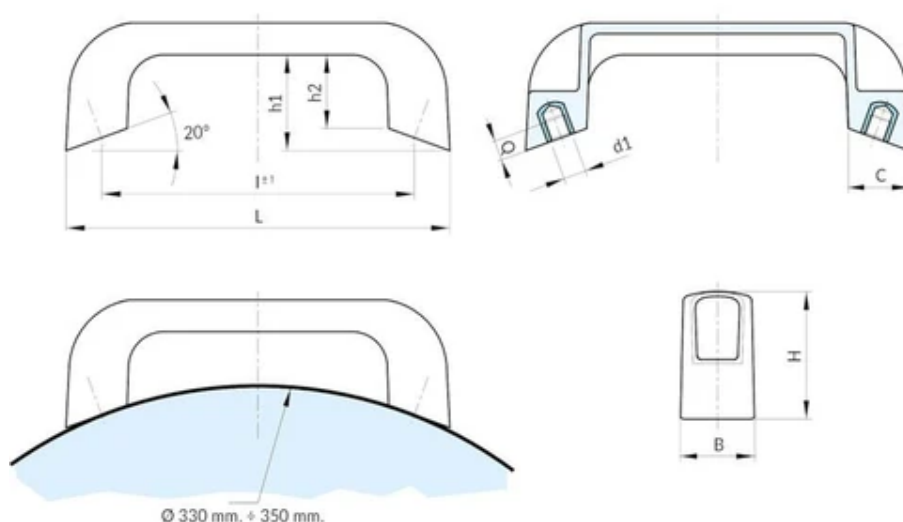

| Code | art. | L | I ±1 | B | H | h1 | h2 | C | d16H | Q | Weight (g) |
|--------------|----------------|-----|------|----|----|----|----|------|------|---|------------|
| B229110.0001 | B229110.TM0601 | 135 | 110 | 26 | 45 | 34 | 26 | 21.5 | M6 | 8 | 55 |
| B229110.0002 | B229110.TM0801 | 135 | 110 | 26 | 45 | 34 | 26 | 21.5 | M8 | 8 | 54 |