

01

# "EUROMODEL" FIXED LEVER WITH THREADED INSERT

Leve fisse

**Materials:**  
Special technopolymer reinforced with high-strength glass fiber.  
Resistant to oils and greases.

**Surface finish:**  
Satin.

**Colour:**  
Black (RAL 9011).

**Inserts:**  
Brass insert with female threaded hole (thread tolerance 6H).

**Special requests:**  
Upon request and for special quantities inserts can be supplied in different materials.  
Upon request and for special quantities available in the colours indicated in the chart.

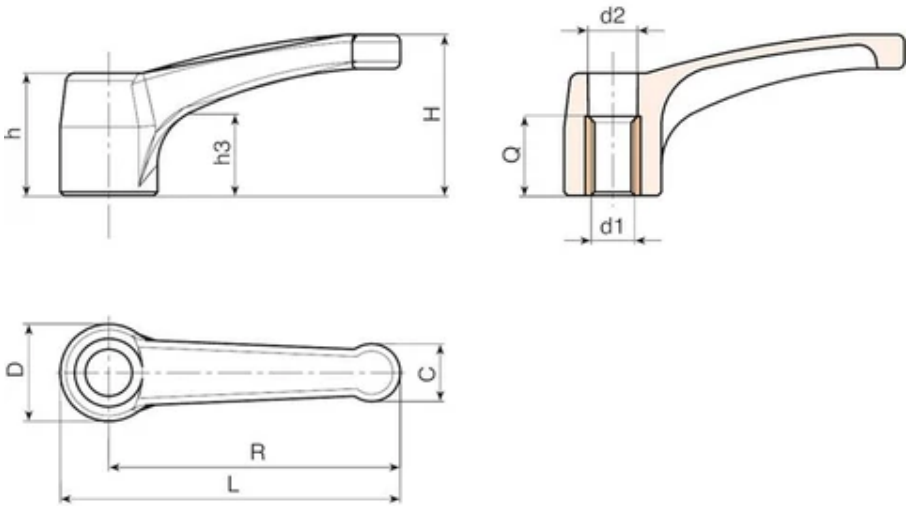

Code	Art.	L	R	H	D	c	h	h1	d2	d1 6H	Q	Weight (g)
A530094.0001	A530094.TM1201	109	94	48.5	30	18	35.5	49	16	M12	22	81