

W297



Al

PA6
+G.F.



ALUMINIUM CONTROL HANDWHEEL WITH SMOOTH BORE AND REVOLVING HANDLE

Materials:

Aluminium.

Surface finish:

Low roughness turned surface.

Colour:

Nickel plated (galvanic treatment).

Alternative colours (min. 50 pieces):

Black epoxy powder coated:
(replace the final letter of the code (H) with letter V (W297100.
AD10V).

Cap:

Central cap in black polyamide (RAL 9011 code 01).

Alternative cap colours:

The central cap for the black handwheel will be grey (RAL 7035 code
no. 13).

Lateral handle:

Revolving handle art. M129 [page].

Hole:

Smooth through hole, remachined with H7 tolerance.

Fixing method:

For fixing systems, or execution of keyways or square holes, please
refer to the technical notes attached to the catalogue.

Special Requests:

- Upon request and for special quantities handwheels can be supplied
on customer's drawing with hole diameter d1.

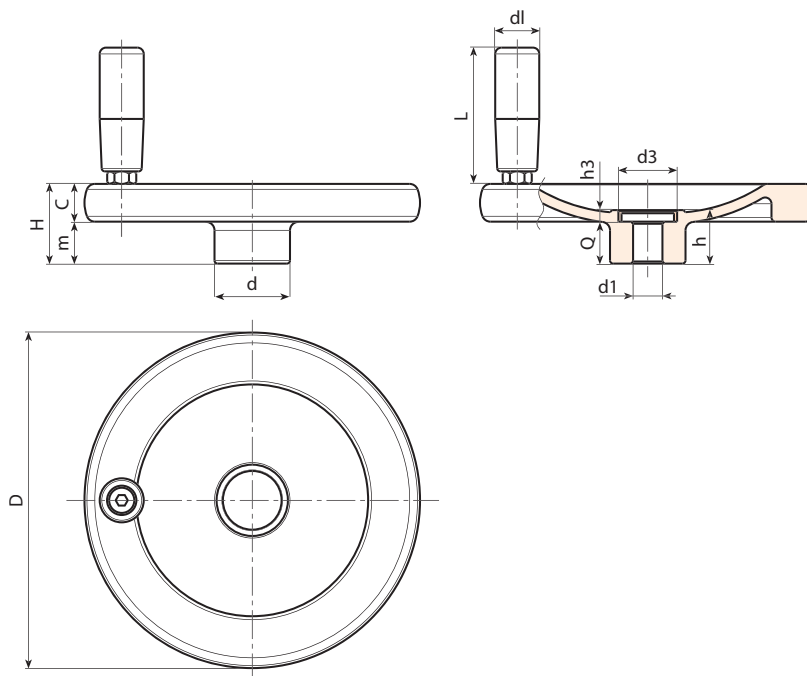

| Code | Art. | d | D | H | m | c | h | h3 | d3 | d1H7 | Q | dl | L | g |
|--------------|---------------|----|-----|----|----|----|------|-----|----|------|------|----|----|------|
| W297080.0001 | W297080.AD08H | 25 | 80 | 26 | 14 | 12 | 21 | 5.5 | 20 | 8 | 15.5 | 20 | 52 | 185 |
| W297100.0001 | W297100.AD10H | 28 | 100 | 28 | 14 | 14 | 21.5 | 5.5 | 20 | 10 | 16 | 20 | 52 | 282 |
| W297130.0001 | W297130.AD12H | 36 | 130 | 35 | 19 | 16 | 25.5 | 5.5 | 28 | 12 | 20 | 23 | 62 | 492 |
| W297160.0001 | W297160.AD14H | 36 | 160 | 38 | 20 | 18 | 25.5 | 5.5 | 28 | 12 | 20 | 25 | 72 | 778 |
| W297200.0001 | W297200.AD16H | 42 | 200 | 44 | 24 | 20 | 31.5 | 6 | 34 | 16 | 25.5 | 25 | 81 | 1287 |

Attention: For a minimum of 50 pieces the diameter d1 can be customised (hole tolerance H7).