

J295



TPV

DD13

UL94
HB



LIGHT TOGGLE CLAMP WITH THRUST ROD AND THREADED ATTACHMENT

Materials:

- (1) TPV thermoplastic rubber handle. Hardness 75 Shore.
- (2) Sheared and bent base and lever system in sheet metal (DD13).
- (3) Rotation pins and fixing rivets in stainless steel (Aisi 304).
- (4) Thrust rod with threaded hole in free-cutting steel.
- (5) Steel lock nut, thin series with fine pitch.
- (6) Sheared and bent rectangular washers in sheet metal (DD13) for panel mounting.

Surface finish:

Smooth.

Colour:

- (1) Red (RAL 3000).
- (4) Black-oxide treated.
- (2-5-6) Standard blue galvanising.

Special Requests:

- None.

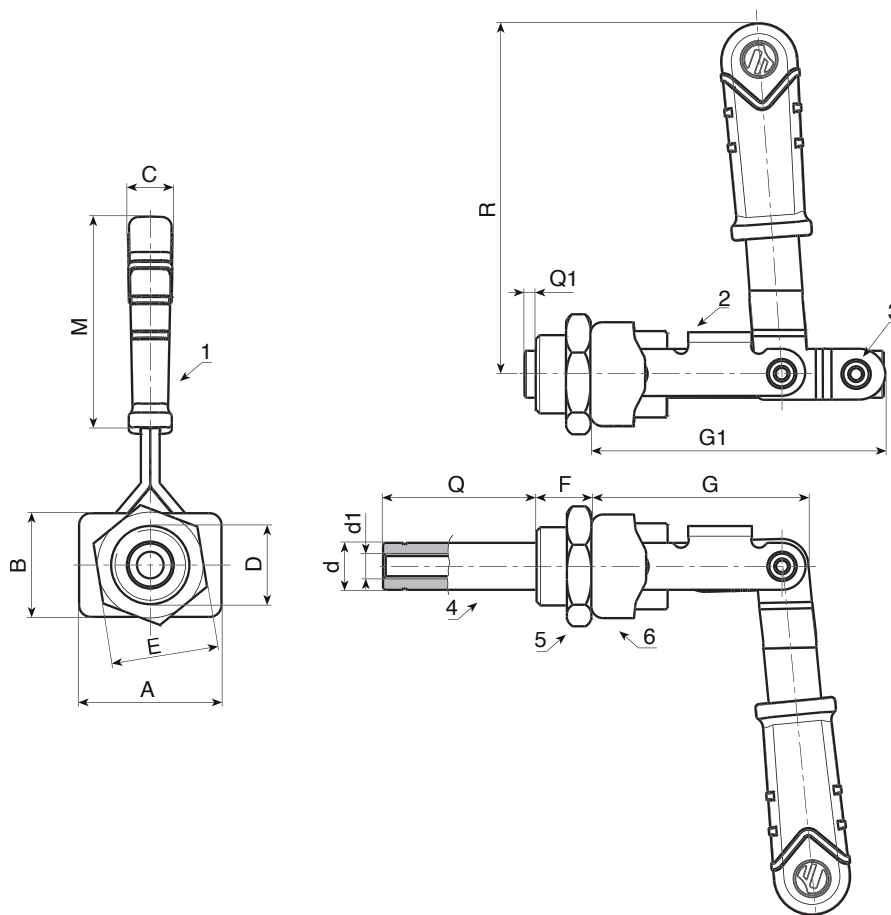
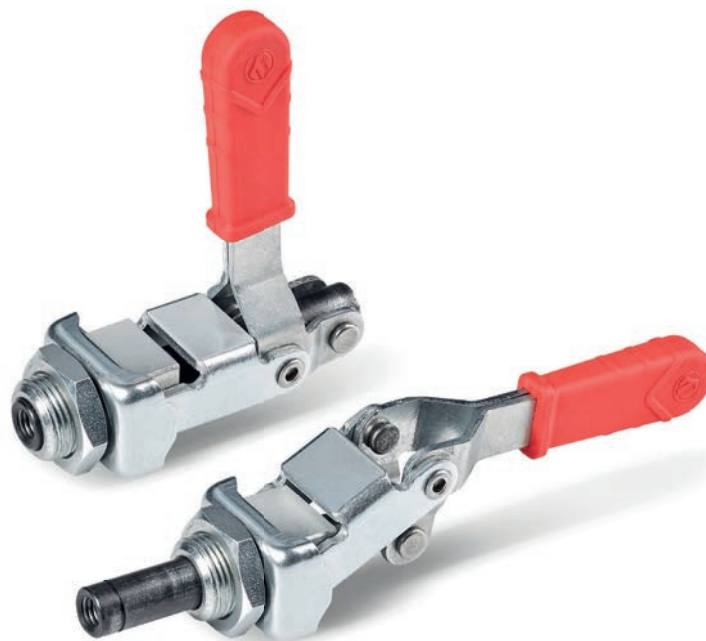

| Code | art. | F1 (Kg) | A | B | C | D | E | F | G | G1 | Q | Q1 | M | R | d | d1 | |
|--------------|--------------|------------|------|------|----|---------|----|----|----|----|------|-----|----|----|----|----|-----|
| J295015.0001 | J295015.FZ16 | 150 | 36,5 | 26,5 | 12 | M20x1,5 | 27 | 14 | 75 | 56 | 38,5 | 1,5 | 53 | 90 | 12 | M8 | 280 |