

W467



C40

Aisi 303



KNURLED METAL HANDWHEEL WITH SHORT HUB AND THREADED HOLE

Materials:

W467:

Steel with strength class 5.8.

W467 PIN:

Stainless steel (Aisi 303).

Surface finish:

Turned with low roughness.

Colour:

W467:

Nickel plated (galvanic treatment).

W467 PIN:

Natural.

Alternative finishes:

Black-oxide treatment:

(replace the final letter of the code (H) with letter B (W46729. SM08B).

Galvanising:

(replace the final letter of the code (H) with letter Z (W46729. SM08Z).

Hole:

Threaded through hole machined from solid metal (thread tolerance 6H).

Special requests:

- Upon request and for special quantities inserts can be supplied to customer's drawing with hole diameter d1.

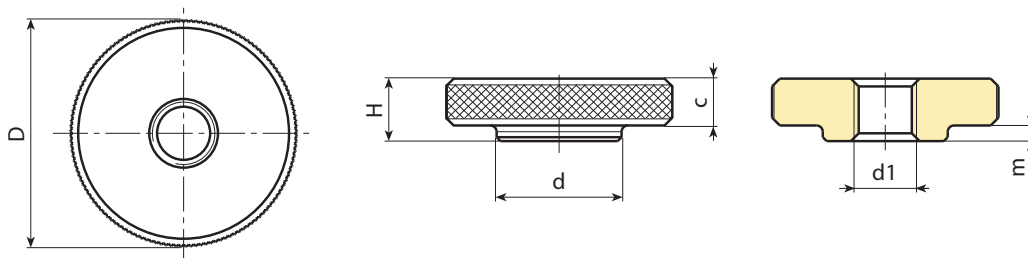

Version W467 - nickel-plated steel

Code	Art.	d	D	H	m	c	d1 _{6H}	
H18015.BM0501	H18015.BM0501	6	11	3	-	3	M3	2
H18015.BM0501	H18015.BM0501	8	15	4	-	4	M4	5
H18015.BM0501	H18015.BM0501	10	19	5	1	4	M5	9
H18015.BM0501	H18015.BM0501	12	23	6	1	5	M6	16
H18015.BM0501	H18015.BM0501	16	29	8	2	6	M8	32
H18015.BM0501	H18015.BM0501	20	35	10	2	8	M10	61
H18015.BM0501	H18015.BM0501	22	39	12	2	10	M12	92

Version W467 PIN - stainless steel (Aisi 303)

INOX

Code	Art.	d	D	H	m	c	d1 _{6H}	
H18015.BM0501	H18015.BM0501	6	11	3	-	3	M3	2
H18015.BM0501	H18015.BM0501	8	15	4	-	4	M4	5