

# W464



C40

Aisi 303



## KNURLED METAL HANDWHEEL WITH THREADED STUD

### Materials:

#### W464:

Steel with strength class 5.8.

#### W464CIN:

Stainless steel (Aisi 303).

### Surface finish:

Turned with low roughness.

### Colour:

#### W464:

Nickel plated (galvanic treatment).

#### W464 CIN:

Natural.

### Alternative finishes:

#### Black-oxide treatment:

(replace the final letter of the code (H) with letter B (W46429.SM08X..B).

#### Galvanising:

(replace the final letter of the code (H) with letter Z (W46429.SM08X..Z).

### Stud:

Threaded stud machined from solid metal (thread tolerance 6g).

### Special requests:

- Upon request and for special quantities inserts can be supplied with customised lengths.

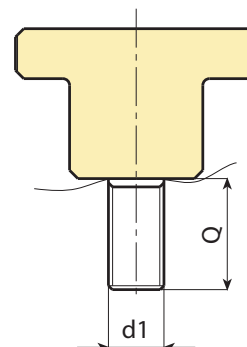
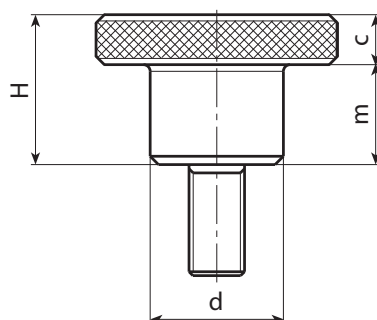
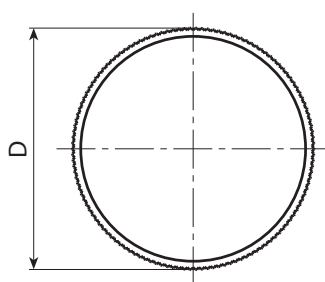

### Version W464 - nickel-plated steel

Code	Art.	d	D	H	m	c	Q Max	d1 <sub>6g</sub>	Q	
-	H18015.BM0501	6	11	8	5	3	16	M3	16	5
-	H18015.BM0501	8	15	10	6	4	20	M4	10	7.8
-	H18015.BM0501	10	19	12	8	4	20	M5	16	15,6
-	H18015.BM0501	10	19	12	8	4	20	M5	30	17
-	H18015.BM0501	12	23	15	10	5	30	M6	16	27,5
-	H18015.BM0501	12	23	15	10	5	30	M6	35	30,5
-	H18015.BM0501	16	29	18	12	6	40	M8	16	55
-	H18015.BM0501	16	29	18	12	6	40	M8	30	59
-	H18015.BM0501	20	35	23	15	8	40	M10	25	109.5

Customised stud length available for a minimum of 100 pieces.  
Qmax = maximum turning length.

### Version W464 CIN - stainless steel (Aisi 303)

Code	Art.	d	D	H	m	c	Q MAX	d1 <sub>6g</sub>	Q	
-	H18015.BM0501	12	23	15	10	5	30	M6	35	30.5

Customised stud length available for a minimum of 100 pieces.  
Qmax = maximum turning length.

INOX