

# G792

## CYLINDRICAL HANDWHEEL WITH SMOOTH HOLE INSERT

+135°  
-30°

PA6  
+G.F.

UL94  
HB

RoHS  
COMPLIANT

### Materials:

Reinforced polyamide.  
Resistant to oils and greases.

### Surface finish:

Satin.

### Colour:

Black (RAL 9011).

### Inserts:

Galvanised steel insert with smooth through bore (tolerance H10).

### Special requests:

- Upon request and for special quantities inserts can be supplied with custom hole diameter  $d_1$ .
- Upon request and for special quantities inserts can be supplied in different materials/with different coatings.
- Upon request and for special quantities available in the colours indicated in the chart [page ].

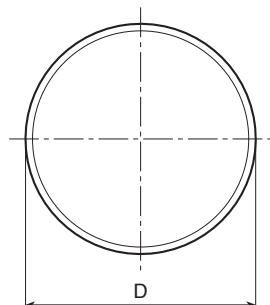
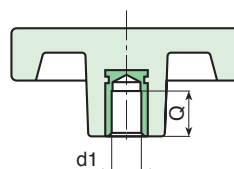
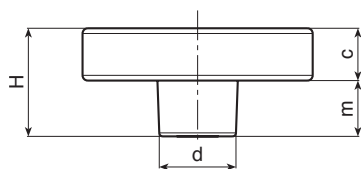

Code	art.	D	H	d	c	m	Dm	d1 <sub>H10</sub>	Q	
-	G79250.TD0601	50	30	22	15	15	12	06	20	62
-	G79266.TD1001	65	30	22	15	15	12	10	20	78

Attention: for a minimum of 200 pieces the diameter  $d_1$  can be produced with the requested dimensions with H10 tolerance.  
Dm = Maximum obtainable diameter for subsequent machining (widening)