

F278

6-LOBE HANDWHEEL WITH STEEL HUB AND THREADED STUD



Materials:

Reinforced polyamide.
Resistant to oils and greases.

Surface finish:

Satin.

Colour:

Black (RAL 9011).

Inserts:

F278: Galvanised steel insert with threaded stud (thread tolerance 6g).

F278CIN: Stainless steel insert with threaded stud (Aisi 303) (thread tolerance 6g).

Special requests:

- Upon request and for special quantities inserts can be supplied with customised lengths.
- Upon request and for special quantities available in the colours indicated in the chart (attention: reduced range) [page].

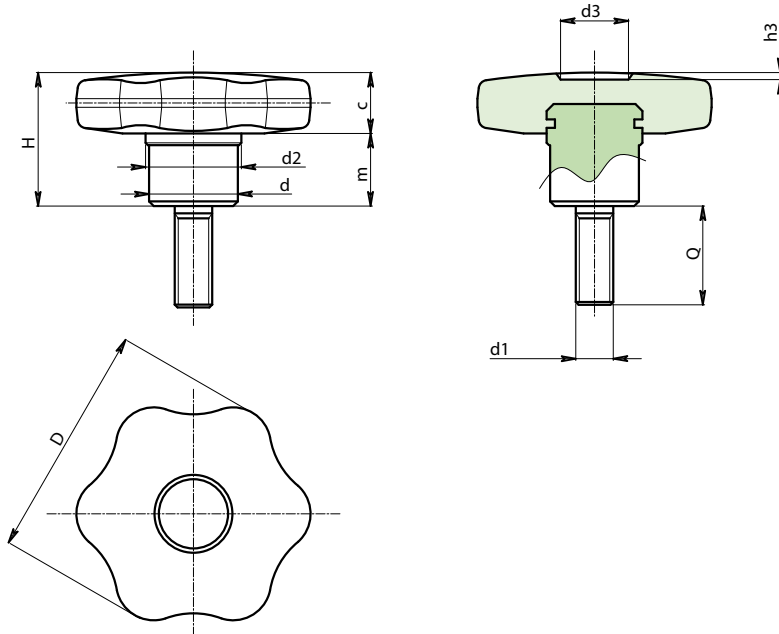

Version F278: Galvanised steel hub.

Code	Art.	D	d	d2	d3	H	h3	m	c	d1 _{6g}	Q	LM	g
-	F27840.TM08X3001	40	15	17	11	24	6	12	12	M8	30	55	54
-	F27850.TM10X4001	50	18	20	13	29	7	15	14	M10	40	60	96
-	F27860.TM12X4001	60	20	24	16	34	6	18	16	M12	40	60	-

LM = Maximum mouldable length.
Customised stud lengths available for a minimum of 150 pieces.

Version F278 CIN: Stainless steel hub (Aisi 303).

Code	Art.	D	d	d2	d3	H	h3	m	c	d1 _{6g}	Q	LM	g
-	F27840.TM08X3001CIN	40	15	17	11	24	6	12	12	M8	30	45	54
-	F27850.TM10X4001CIN	50	18	20	13	29	7	15	14	M10	40	50	-
-	F27860.TM12X4001CIN	60	20	24	16	34	6	18	16	M12	40	50	-

LM = Maximum mouldable length.
Customised stud lengths available for a minimum of 150 pieces.

