

F270



HIGH CLAMPING STAR HANDWHEEL WITH THREADED STUD

Materials:

Reinforced polyamide.
Resistant to oils and greases.

Surface finish:

Satin.

Colour:

Black (RAL 9011).

Inserts:

Nickel-plated brass insert with threaded stud (thread tolerance 6g).

Special Requests:

- Upon request and for special quantities inserts can be supplied with customised lengths.
- Upon request and for special quantities available in the colours indicated in the chart (attention: reduced range) [page].

ATTENTION:

For a standard lock turn the knob. For a tighter lock, use a hex wrench to tighten the hex nut.

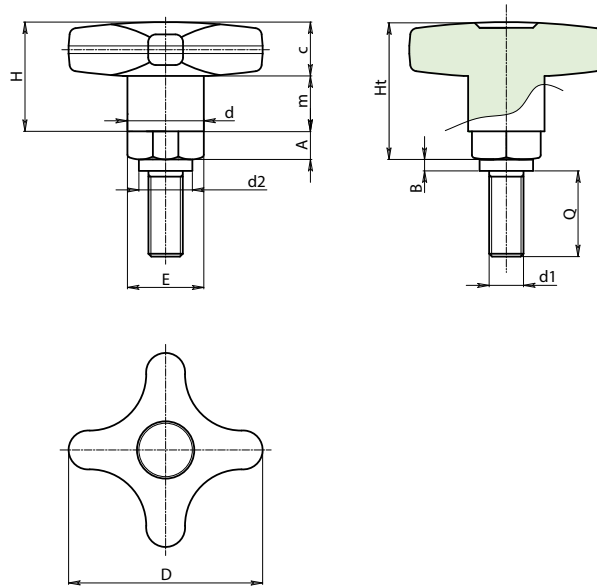

| Code | Art. | D | d | d2 | H | Ht | A | B | E | m | c | d1 _{6g} | Q | g |
|------|------------------|----|----|----|----|----|----|---|----|----|----|------------------|----|----|
| - | F27050.TM10X2501 | 50 | 18 | 15 | 24 | 34 | 10 | 4 | 17 | 15 | 14 | M10 | 25 | 97 |