

W298



Al

PA6
+G.F.

UL94
HB



ALUMINIUM CONTROL HANDWHEEL WITH SMOOTH BORE AND REVOLVING FOLDING HANDLE

Materials:

Die-cast aluminium.

Surface finish:

Satin finish, except for the sections (T) with low surface roughness obtained by turning.

Colour:

Nickel plated (galvanic treatment).

Alternative colours (min. 50 pieces):

Black epoxy powder coated:
(replace the final letter of the code (H) with letter V (W298100.AD10V).

Cap:

Central cap in black polyamide (RAL 9011 code 01).

Alternative cap colours:

The central cap for the black handwheel will be grey (RAL 7035 code no. 13).

Lateral handle:

Revolving, folding handle art. M136 [page].

Hole:

Smooth through hole, remachined with H7 tolerance.

Special Requests:

- Upon request and for special quantities handwheels can be supplied on customer's drawing with hole diameter d1.

Fixing method:

For fixing systems, or execution of keyways or square holes, please refer to the technical notes attached to the catalogue.

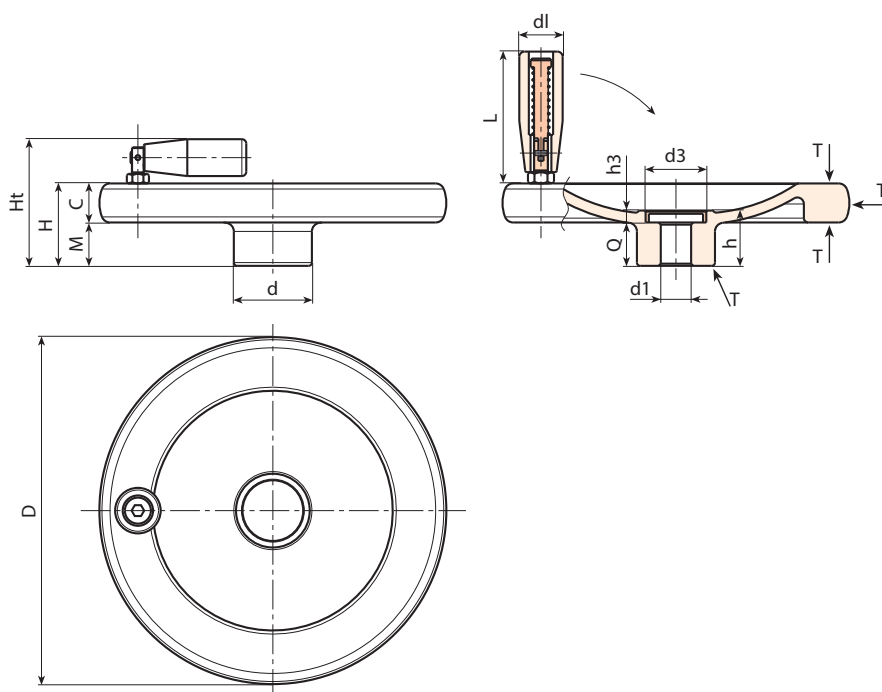

Code	Art.	d	D	H	m	c	h	h3	d3	d1H7	Q	dl	L	g
-	W298080.AD08H	26	80	26	14	12	21	5.5	20	8	15.5	20	56	181
-	W298100.AD10H	28	100	28	14	14	21.5	5.5	20	10	16	20	56	279
-	W298130.AD12H	36	130	35	19	16	25.5	5.5	28	12	20	25	76	506
-	W298160.AD14H	36	160	38	20	18	25.5	5.5	28	12	20	25	76	756
-	W298200.AD16H	42	200	44	24	20	31.5	6	34	16	25.5	26	89	1337

Attention: For a minimum of 50 pieces the diameter d1 can be customised (hole tolerance H7).